

STREAMLINED SHAFT ANODES / imperial

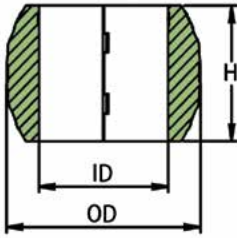

	PID	LB	KG		H	OD	ID	UPC
Al	CMX21AL	4.80	2.18	mm	89	198	152	6 28309 17582 5
Mg	CMX21M	3.10	1.40					6 28309 24393 7
Zn	CMX21	12.00	5.44	in	3.5	7.8	6	6 28309 12796 1

STREAMLINED SHAFT ANODES / metric

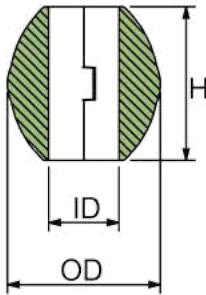

CMX00-CMX09

	PID	LB	KG		H	OD	ID	UPC
Al	CMXM20A	0.30	0.13	mm	48	51.2	20	6 28309 23863 6
Mg	CMXM20M	0.20	0.09					6 28309 23864 3
Zn	CMXM20Z	0.73	0.33	in	1.89	2.02	0.79	6 28309 23862 9
Al	CMX22A	0.279	0.127	mm	48	51.2	22	6 28309 23840 7
Mg	CMX22M	0.187	0.085					6 28309 23841 4
Zn	CMX22Z	0.685	0.311	in	1.89	2.01	0.86	6 28309 23842 1
Al	CMX25AL	0.480	0.217	mm	55	61	25	6 28309 12765 7
Mg	CMX25M	0.312	0.141					6 28309 24394 4
Zn	CMX25	1.216	0.551	in	2.17	2.40	1	6 28309 10379 8
Al	CMX28AL	0.51	0.23	mm	56	61	28	6 28309 23843 8
Mg	CMX28M	0.33	0.15					6 28309 23844 5
Zn	CMX28	1.28	0.58	in	2.20	2.40	1.10	6 28309 23845 2
Al	CMX30AL	0.486	0.220	mm	61	61	30	6 28309 12766 4
Mg	CMX30M	0.316	0.143					6 28309 12778 7
Zn	CMX30	1.228	0.557	in	2.40	2.40	1.18	6 28309 10380 4
Al	CMX34AL	0.68	0.31	mm	65	70	34	6 28309 21521 7
Mg	CMX34M	0.44	0.20					6 28309 21522 4
Zn	CMX34	1.73	0.79	in	2.60	2.75	1.34	6 28309 22962 7
Al	CMX35AL	0.630	0.285	mm	65	70	35	6 28309 12767 1
Mg	CMX35M	0.410	0.186					6 28309 12779 4
Zn	CMX35	1.610	0.730	in	2.62	2.75	1.38	6 28309 10381 1
Al	CMX40AL	1.222	0.554	mm	73	84	40	6 28309 12768 8
Mg	CMX40M	0.784	0.355					6 28309 12780 0
Zn	CMX40	3.152	1.429	in	2.87	3.30	1.57	6 28309 10382 8
Al	CMX45AL	1.082	0.490	mm	73	84	45	6 28309 12769 5
Mg	CMX45M	0.694	0.314					6 28309 12781 7
Zn	CMX45	2.782	1.262	in	2.87	3.30	1.77	6 28309 11530 2
Al	CMX50AL	0.924	0.419	mm	73	84	50	6 28309 12770 1
Mg	CMX50M	0.594	0.269					6 28309 12782 4
Zn	CMX50	2.370	1.075	in	2.87	3.30	2	6 28309 10383 5
Al	CMX55AL	2.41	1.09	mm	90	105	55	6 28309 19282 2
Mg	CMX55M	1.59	0.72					6 28309 22964 1
Zn	CMX55	6.03	2.73	in	3.54	4.13	2.17	6 28309 12821 0
Al	CMX60A	2.342	1.062	mm	95.25	106.2	60	6 28309 19335 5
Mg	CMX60M	1.536	0.696					6 28309 19343 0
Zn	CMX60	5.882	2.668	in	3.75	4.18	2.36	6 28309 12580 6

SHAFT & RUDDER ANODES

- Interlocking halves

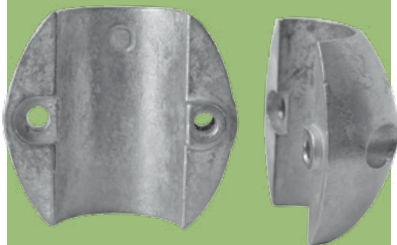

- Full shaft contact (100% CIRCULAR RADIUS)
- Extra alloy around fastener

Protect your boat, respect our waters.